

LX5 High Density LGX 4U Patch Panel

An innovative 4U, 19" rack mountable patch panel, designed for use in high density applications. It offers management of up to 384 fibres using MTP® optical cassettes with 24 fibres each and it's fully compatible with a variety of alternative LGX module options.

When used for fusion splicing it can house up to 24 fibres, using 24 fibre splice trays and the customer can choose from a wide variety of adaptor loaded LGX plates. This panel made by high quality cold roll steel material; the surface is with electrostatic powder spraying. It is sliding type 4U height for 19inch rack mounted application. It can support 16pcs MPO/MTP® cassettes MLX5 for max. 384 fibre connection and distribution. There is cable fixing kit at back side of patch panel and with cable management rings at front side of patch panel. It has front and rear metal doors.

The MLX5 LGX MTP® modules which are compatible with LX5 panel are designed for the transition between MTP® and standard LC connectors. They have a small form factor design and LX5 panel can house up to 16 MLX5 modules in 4U height. They come with 12 low loss LC duplex adaptors on the front and 2 MTP® on the back side. They contain 100% factory terminated and tested LC to MTP® fanouts.

Features

- 4U height
- 19" rack mountable
- Up to 16 LGX modules
- Compatible with 24 fibre splice trays
- Up to 384 fibres
- Metal construction
- Compatible with multiple LGX module options (MTP®, adaptors, etc.)

Applications

- Data centres
- High density applications
- Telecommunication networks
- Enterprise Networks
- Central Offices

Specifications

Patch Panel

ELEMENT	CHARACTERISTIC
Depth (mm) A	353mm
Width (mm) B	442mm
Height (mm) C	175.5mm
Rack Units	4U
Capacity	16 x LGX type modules

MTP® Connector Performance

CONNECTOR MATING	IL AVERAGE	IL MAX	RETURN LOSS
MTP® Elite (MM)	0.10dB	0.35dB	N/A
MTP® (MM)	0.20dB	0.60dB	N/A
MTP® Elite (SM)	0.10dB	0.35dB	>60dB
MTP® (SM)	0.25dB	0.75dB	>60dB

Standards Compliance

- TIA/EIA-568-C.3 and ISO/IEC 11801 - cable
- IEC-61754-7 & EIA/TIA-604-5 - MTP®
- Compliant to Directive 2002/95/EC (RoHS) and REACH SvHC
- IEC-61754-20 (LC) & IEC-61754-14 (SC)
- IEC-60793

Ordering Information

DESCRIPTION	PART NUMBER
Optronics LX5 High Density LGX 4U Patch Panel Unloaded	OPPLX5-XX-XX-UL-4
24F Splicing kit, with 24F splicer tray, 25 protector, 2 PG Nuts	OFMST24-LX5
Blank LGX Plate	OPLXBL-2
Empty LGX Plate For 12 x SC Simplex/LC Duplex UPC Adaptors Singlemode Blue	OPLX2-XX-9X-UL
Empty LGX Plate For 12 x SC Simplex/LC Duplex APC Adaptors Singlemode Green	OPLX2-XX-9X-UL-1
Empty LGX Plate For 12 x SC Simplex/LC Duplex Adaptors OM3 Aqua	OPLX2-XX-3X-UL
Empty LGX Plate For 12 x SC Simplex/LC Duplex Adaptors OM4 Erika Violet	OPLX2-XX-4X-UL
Empty LGX Plate For 6 x MPO/MTP® Male or MPO/MTP Male Elite Adaptors Singlemode	OPLX0-XX-9X-UL
Empty LGX Plate For 6 MPO/MTP® Male or MPO/MTP Male Elite Adaptors OM3	OPLX0-XX-3X-UL
Empty LGX Plate For 6 x MPO/MTP® Male or MPO/MTP Male Elite Adaptors OM4	OPLX0-XX-4X-UL

Note:

For 48F Splicing kit, with 48F splicer tray, 50 protector, 4 PG Nuts: 2 splice trays OFMST24-LX5 stack together with 50 protector, 4 PG Nuts

For 72F Splicing kit, with 72F splicer tray, 75 protector, 4 PG Nuts: 3 splice trays OFMST24-LX5 stack together with 75 protector, 4 PG Nuts

For 96F Splicing kit, with 96F splicer tray, 100 protector, 4 PG Nuts: 4 splice trays OFMST24-LX5 stack together with 100 protector, 4 PG Nuts

LC LGX Plates configuration

DESCRIPTION	PART NUMBER
LGX Plate with 12 x LC Duplex Multimode Beige Adaptors	OPLX2-00-22-12
LGX Plate with 12 x LC Duplex Multimode OM3 Aqua Adaptors	OPLX2-00-32-12
LGX Plate with 12 x LC Duplex Multimode OM4 Erika Violet Adaptors	OPLX2-00-42-12
LGX Plate with 12 x LC Duplex Singlemode Blue Adaptors	OPLX2-00-92-12
LGX Plate with 12 x LC Duplex Singlemode APC Green Adaptors	OPLX2-01-92-12
LGX Plate with 6 x LC Duplex Multimode Beige Adaptors	OPLX2-00-22-06
LGX Plate with 6 x LC Duplex Multimode OM3 Aqua Adaptors	OPLX2-00-32-06
LGX Plate with 6 x LC Duplex Multimode OM4 Erika Violet Adaptors	OPLX2-00-42-06
LGX Plate with 6 x LC Duplex Singlemode Blue Adaptors	OPLX2-00-92-06
LGX Plate with 6 x LC Duplex Singlemode APC Green Adaptors	OPLX2-01-92-06

SC LGX Plates configuration

DESCRIPTION	PART NUMBER
LGX Plate with 12 x SC Simplex Multimode Beige Adaptors	OPLX2-02-21-12
LGX Plate with 12 x SC Simplex Multimode OM3 Aqua Adaptors	OPLX2-02-31-12
LGX Plate with 12 x SC Simplex Multimode OM4 Erika Violet Adaptors	OPLX2-02-41-12
LGX Plate with 12 x SC Simplex Singlemode Blue Adaptors	OPLX2-02-91-12
LGX Plate with 12 x SC Simplex Singlemode APC Green Adaptors	OPLX2-03-91-12

MPO/MTP® LGX Plates configuration

DESCRIPTION	PART NUMBER
LGX Plate with 6 x MTP® Male Adaptors Singlemode	OPLX0-20-91-06
LGX Plate with 6 x MTP® Male Elite Adaptors Singlemode	OPLX0-24-91-06
LGX Plate with 6 x MTP® Male Adaptors OM3	OPLX0-20-31-06
LGX Plate with 6 x MTP® Male Elite Adaptors OM3	OPLX0-24-31-06
LGX Plate with 6 x MTP® Male Adaptors OM4	OPLX0-20-41-06
LGX Plate with 6 x MTP® Male Elite Adaptors OM4	OPLX0-24-41-06
LGX Plate with 6 x MPO Male Adaptors Singlemode	OPLX0-21-91-06
LGX Plate with 6 x MPO Male Elite Adaptors Singlemode	OPLX0-25-91-06
LGX Plate with 6 x MPO Male Adaptors OM3	OPLX0-21-31-06
LGX Plate with 6 x MPO Male Elite Adaptors OM3	OPLX0-25-31-06
LGX Plate with 6 x MPO Male Adaptors OM4	OPLX0-21-41-06
LGX Plate with 6 x MPO Male Elite Adaptors OM4	OPLX0-25-41-06
LGX Plate with 4 x MTP® Male Adaptors Singlemode	OPLX0-20-91-04
LGX Plate with 4 x MTP® Male Elite Adaptors Singlemode	OPLX0-24-91-04
LGX Plate with 4 x MTP® Male Adaptors OM3	OPLX0-20-31-04
LGX Plate with 4 x MTP® Male Elite Adaptors OM3	OPLX0-24-31-04
LGX Plate with 4 x MTP® Male Adaptors OM4	OPLX0-20-41-04
LGX Plate with 4 x MTP® Male Elite Adaptors OM4	OPLX0-24-41-04
LGX Plate with 4 x MPO Male Adaptors Singlemode	OPLX0-21-91-04
LGX Plate with 4 x MPO Male Elite Adaptors Singlemode	OPLX0-25-91-04
LGX Plate with 4 x MPO Male Adaptors OM3	OPLX0-21-31-04

LGX Plate with 4 x MPO Male Elite Adaptors OM3	OPLX0-25-31-04
LGX Plate with 4 x MPO Male Adaptors OM4	OPLX0-21-41-04
LGX Plate with 4 x MPO Male Elite Adaptors OM4	OPLX0-25-41-04

MLX5 MTP® Cassette Module

DESCRIPTION	PART NUMBER
Optronics LC to MTP® Male MLX5 LGX Cassette Module with 12 LC Duplex OM3 Aqua Adaptors Polarity A	OMLX5-20003212-A
Optronics LC to MTP® Male Elite MLX5 LGX Cassette Module with 12 LC Duplex OM3 Aqua Adaptors Polarity A	OMLX5-24003212-A
Optronics LC to MTP® Male MLX5 LGX Cassette Module with 12 LC DuplexOM4 Erika Violet Adaptors Polarity A	OMLX5-20004212-A
Optronics LC to MTP® Male Elite MLX5 LGX Cassette Module with 12 LC DuplexOM4 Erika Violet Adaptors Polarity A	OMLX5-24004212-A
Optronics LC to MTP® Male MLX5 LGX Cassette Module with 12 LC Duplex SM Blue Adaptors Polarity A	OMLX5-20009212-A
Optronics LC to MTP® Male Elite MLX5 LGX Cassette Module with 12 LC Duplex SM Blue Adaptors Polarity A	OMLX5-24009212-A
Optronics LC to MTP® Male MLX5 LGX Cassette Module with 12 LC Duplex SM APC Green Adaptors Polarity A	OMLX5-20019212-A
Optronics LC to MTP® Male Elite MLX5 LGX Cassette Module with 12 LC Duplex SM Green Adaptors Polarity A	OMLX5-24019212-A
Optronics LC to MTP® Male MLX5 LGX Cassette Module with 6 LC Duplex OM3 Aqua Adaptors Polarity A	OMLX5-20003206-A
Optronics LC to MTP® Male Elite MLX5 LGX Cassette Module with 6 LC Duplex OM3 Aqua Adaptors Polarity A	OMLX5-24003206-A
Optronics LC to MTP® Male MLX5 LGX Cassette Module with 6 LC DuplexOM4 Erika Violet Adaptors Polarity A	OMLX5-20004206-A
Optronics LC to MTP® Male Elite MLX5 LGX Cassette Module with 6 LC DuplexOM4 Erika Violet Adaptors Polarity A	OMLX5-24004206-A
Optronics LC to MTP® Male MLX5 LGX Cassette Module with 6 LC Duplex SM Blue Adaptors Polarity A	OMLX5-20009206-A
Optronics LC to MTP® Male Elite MLX5 LGX Cassette Module with 6 LC Duplex SM Blue Adaptors Polarity A	OMLX5-24009206-A
Optronics LC to MTP® Male MLX5 LGX Cassette Module with 6 LC Duplex SM APC Green Adaptors Polarity A	OMLX5-20019206-A
Optronics LC to MTP® Male Elite MLX5 LGX Cassette Module with 6 LC Duplex SM Green Adaptors Polarity A	OMLX5-24019206-A
Optronics LC to MPO Male MLX5 LGX Cassette Module with 12 LC Duplex OM3 Aqua Adaptors Polarity A	OMLX5-21003212-A
Optronics LC to MPO Male Elite MLX5 LGX Cassette Module with 12 LC Duplex OM3 Aqua Adaptors Polarity A	OMLX5-25003212-A
Optronics LC to MPO Male MLX5 LGX Cassette Module with 12 LC DuplexOM4 Erika Violet Adaptors Polarity A	OMLX5-21004212-A
Optronics LC to MPO Male Elite MLX5 LGX Cassette Module with 12 LC DuplexOM4 Erika Violet Adaptors Polarity A	OMLX5-25004212-A
Optronics LC to MPO Male MLX5 LGX Cassette Module with 12 LC Duplex SM Blue Adaptors Polarity A	OMLX5-21009212-A
Optronics LC to MPO Male Elite MLX5 LGX Cassette Module with 12 LC Duplex SM Blue Adaptors Polarity A	OMLX5-25009212-A
Optronics LC to MPO Male MLX5 LGX Cassette Module with 12 LC Duplex SM APC Green Adaptors Polarity A	OMLX5-20019212-A
Optronics LC to MPO Male Elite MLX5 LGX Cassette Module with 12 LC Duplex SM Green Adaptors Polarity A	OMLX5-24019212-A
Optronics LC to MPO Male MLX5 LGX Cassette Module with 6 LC Duplex OM3 Aqua Adaptors Polarity A	OMLX5-21003206-A
Optronics LC to MPO Male Elite MLX5 LGX Cassette Module with 6 LC Duplex OM3 Aqua Adaptors Polarity A	OMLX5-25003206-A

Optronics LC to MPO Male MLX5 LGX Cassette Module with 6 LC DuplexOM4 Erika Violet Adaptors Polarity A	OMLX5-21004206-A
Optronics LC to MPO Male Elite MLX5 LGX Cassette Module with 6 LC DuplexOM4 Erika Violet Adaptors Polarity A	OMLX5-25004206-A
Optronics LC to MPO Male MLX5 LGX Cassette Module with 6 LC Duplex SM Blue Adaptors Polarity A	OMLX5-21009206-A
Optronics LC to MPO Male Elite MLX5 LGX Cassette Module with 6 LC Duplex SM Blue Adaptors Polarity A	OMLX5-25009206-A
Optronics LC to MPO Male MLX5 LGX Cassette Module with 6 LC Duplex SM APC Green Adaptors Polarity A	OMLX5-20019206-A
Optronics LC to MPO Male Elite MLX5 LGX Cassette Module with 6 LC Duplex SM Green Adaptors Polarity A	OMLX5-24019206-A

For polarity B or C please change the last letter of the part numbers above.

Technical Drawings: (mm)

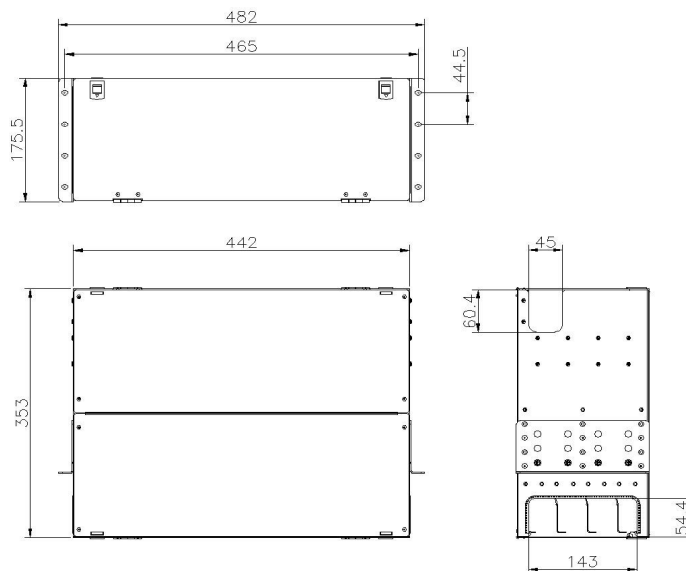

Instruction:

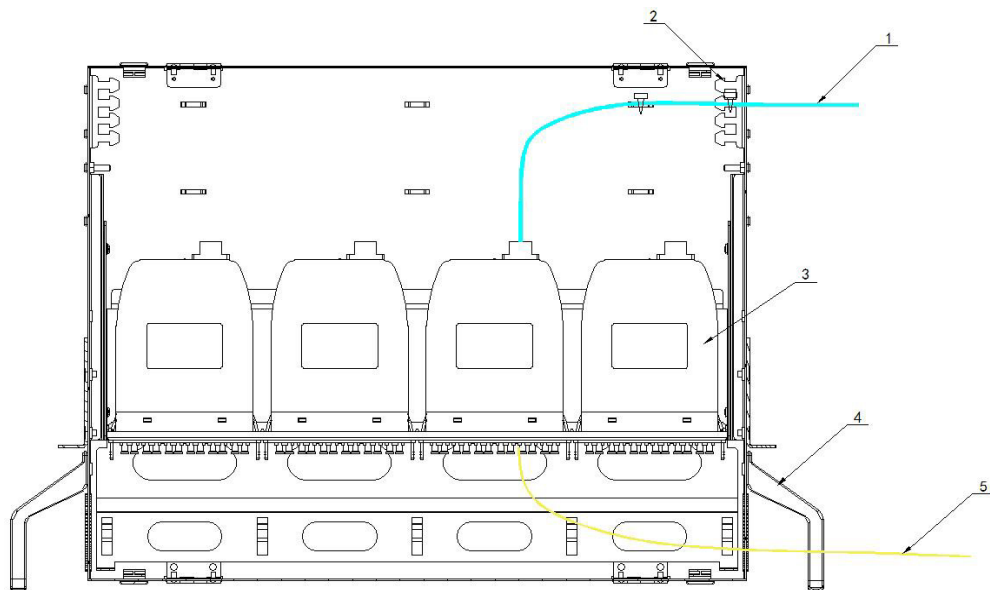

1. MPO/MTP® patch cord 2. Cable fixing kit 3. MPO/MTP® cassette MLX5
4. Cable management rings 5. Fibre optic patch cord

Accessories:

Item	Name	Specification	Qty
1	Mounting hanger	75*19.8*175.5mm	2pcs
2	Round head screw with washer	M4*6/metal/Bright chrome	16pcs
3	Countersunk head screw	M4*8/metal/Bright chrome	12pcs
4	Plastic cable management rings	ODF-PRS-1U/ABS/Black	8pcs
5	Nylon cable tie	3mm*120mm/white	10pcs

Packing information:

Carton	Size	Net weight	Gross weight	Packing qty	Remark
Master carton	50x41x24cm	8.2kgs	9.0kgs	1pc	Master carton 0.8kgs

Note: Above weight is not included the MPO/MTP® cassette MLX5. Each MLX5 is 0.126kgs.

Additional Images:

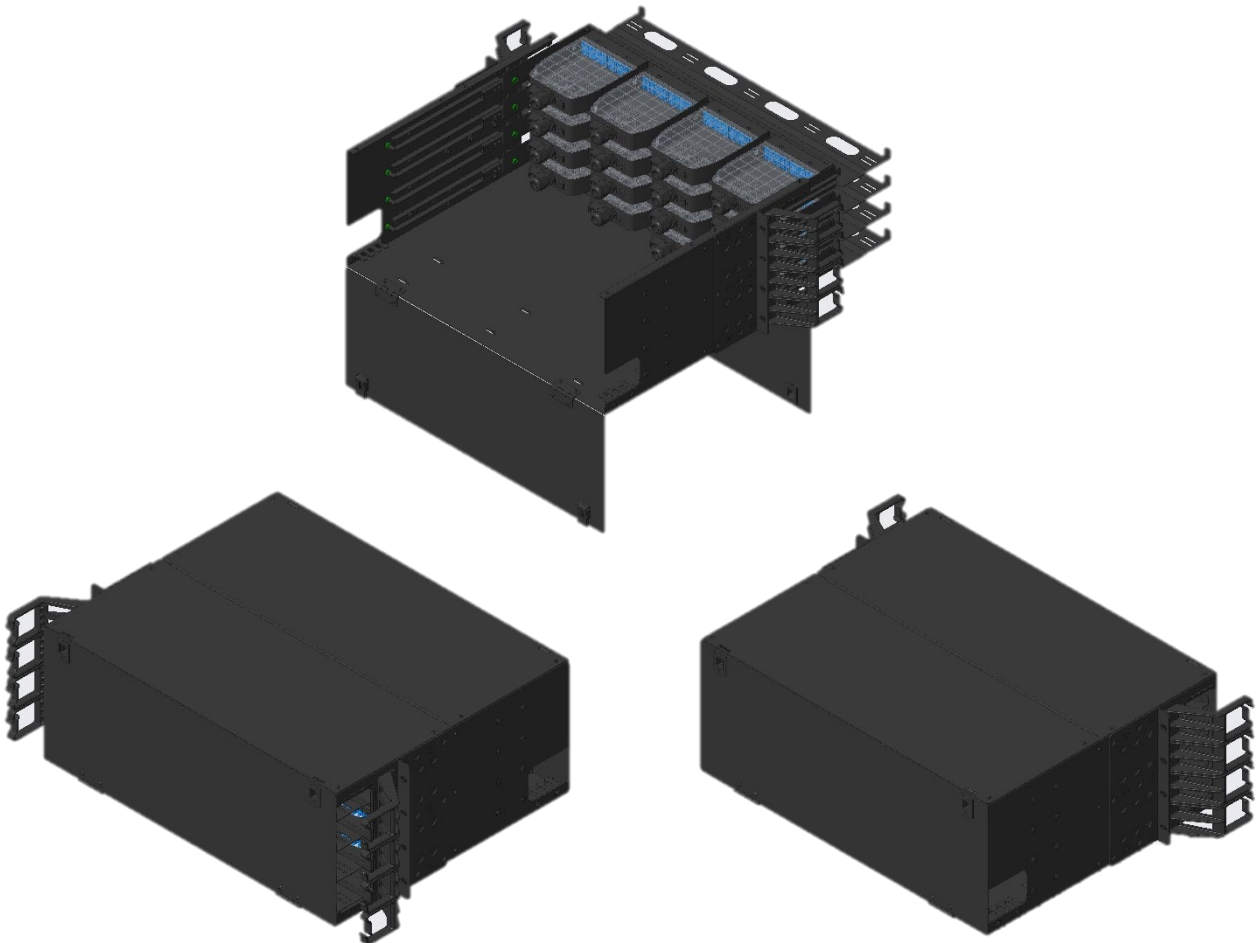

Technical Drawing for Cassette Modules

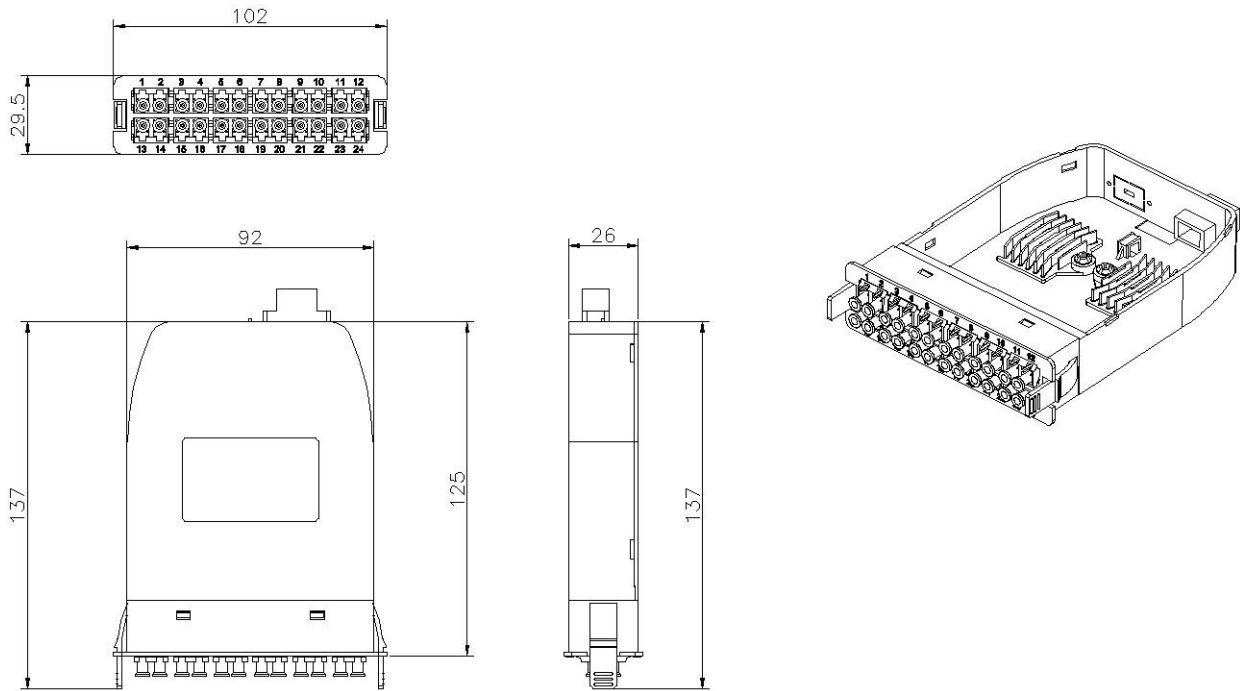

Product configuration:

Fibre type	LC duplex adaptor	Patch cord	Adaptor plate	Cable gland	Splice module
OS2 (UPC)					
OS2 (APC)					
OM3					
OM4					

Note: The standard colour of adaptor plate is black.

Additional Images:

OS2 (UPC)	OS2 (APC)	OM3	OM4
			
			
			

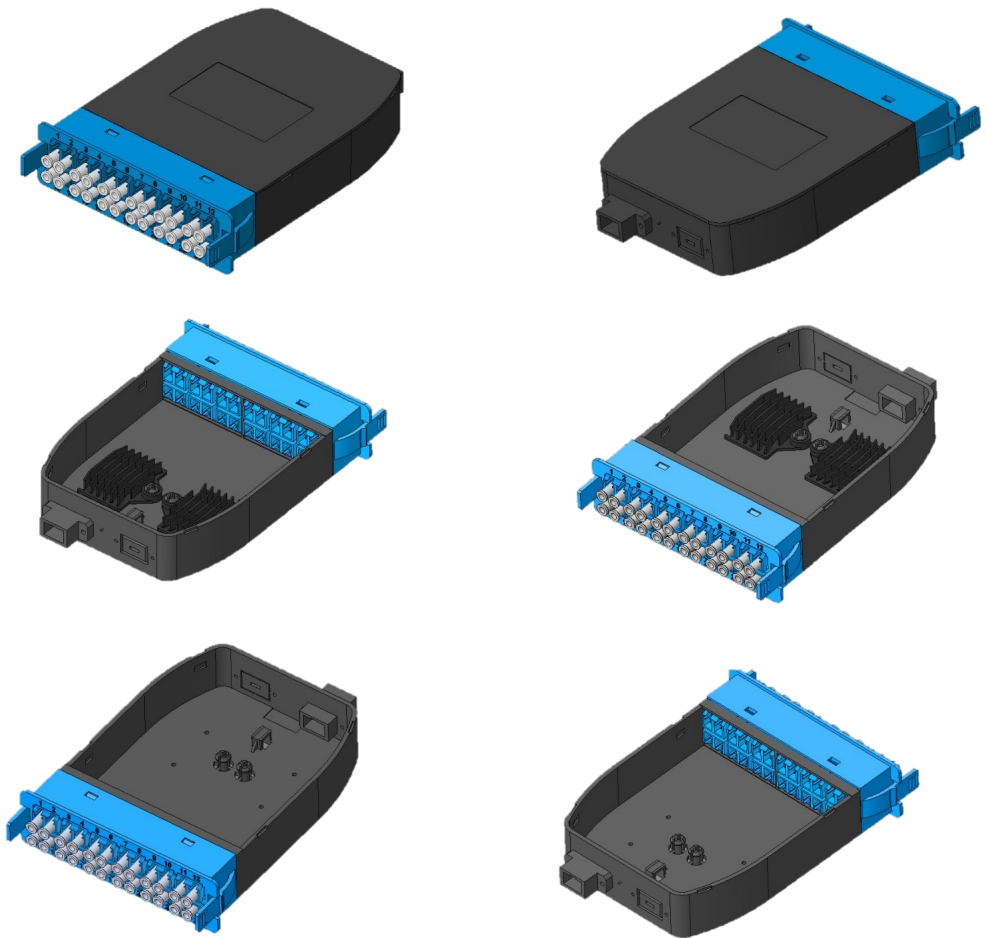

MTP® is a registered trademark of US Conec Ltd.